

Note: Be sure to shut off the water supply and remove your before proceeding with this installation.

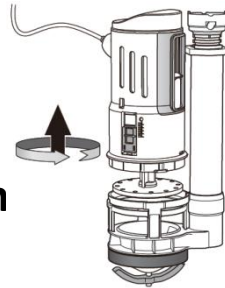

Part 1: Installation of 2" Flush Valve Mechanism (for a one-piece toilet)



1. Hold the base of the flush valve and rotate the body counter-clockwise to remove from base.

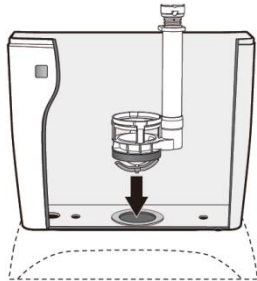

2. Put the base into the ceramic hole. Be sure the steel retaining clip is below the ceramic.

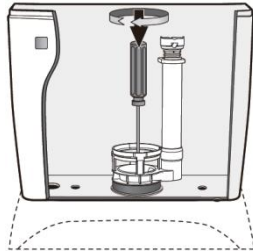

3. Use a screwdriver to tighten up the nut. It must be firm, but do not overly tighten or you could damage the device.

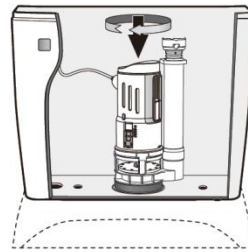

4. Re-attach flush valve body by setting in place; rotate clockwise to lock in place.

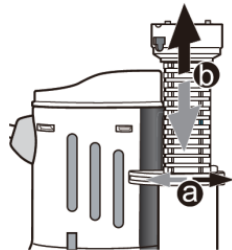

5. Adjust height of the overflow tube; open the slide lock (a), then set the desired height of tube (b). Re-lock the slide lock (a).

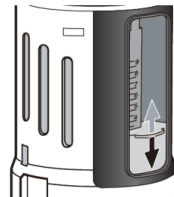

6. Adjust half-flush volume by sliding the blue flow adjuster up or down. When higher, the flush water volume is less. Slide the flow adjuster down a little to arrive at the correct amount of water needed for the 1/2 flush.

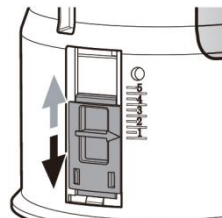

7. Adjust the full flush volume by adjusting the red flow adjuster. When the float is higher, the discharge water volume is less. Slide the flow adjuster down to arrive at the correct amount of water needed for a full flush.

Part 2: Installation of Flush Handle

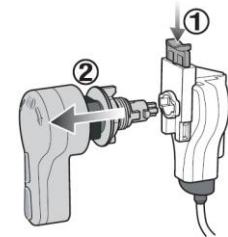

1. Depress blue button (1) which is on the flush handle switch box and then pull handle (2) out.

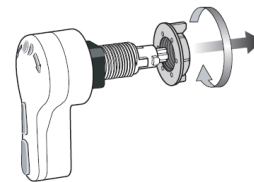

2. Unscrew the flanged nut from the handle body and remove square gasket.

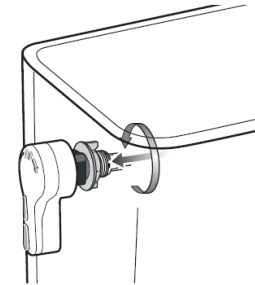

3. On outside of tank, insert square gasket into square tank hole, followed by the flush handle. Screw the flanged nut onto the flush handle threads on inside of the tank.



4. When hanging in the vertical position, make sure the handle swings left & right approx. 90 degrees.

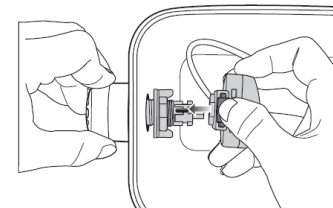

5. **IMPORTANT:** Align the grooves on the flush handle mechanism in the vertical position.

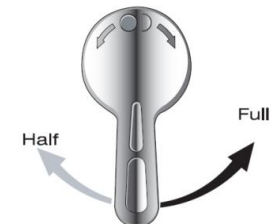

6. Left direction is half flush, the right is full flush.